



Product feature

PMK series are standard type, PMK2 (Φ20~Φ63) series are heavy duty type, and it can support more rotational inertia if the bore size is same.

Specification

Bore(mm)	16	20	25	32	40	50	63
Fluid	Compressed air						
Action	Double acting						
Max. pressure	1.0MPa						
Min. pressure	0.1MPa						
Ambient and fluid temp.	Auto switch : -10~+60°C No switch : -10~+70°C						
Speed range	50~200mm/s						
Cushion	Rubber bumper						
Stroke tolerance	+0.6 -0.4						
Lubrication	Non-lube						
Rotation angle	90°±10°						
Rotation direction	Left • Right						
Rotation stroke	7.5	9.5	15	19			
Grip stroke	10 • 20			20 • 50			
Allowable torque	3.8	7	13	27	47	107	182
Gripping force(0.5MPa)	75	100	185	300	525	825	1400
Non-rotating frequency	±1.2°		±0.9°		±0.7°		
Port size	M5×0.8		Rc1/8		Rc1/4		

Auto switch table

Bore(mm)	Switch model	
	Direct mount	Rail mount
16		
20		
25		
32		
40		
50		
63		

Body options makeable

Bore(mm)	Null	M	F	N	MF	FN
Ø16	●	—	—	●	—	—
Ø20~Ø63	●	●	●	●	●	●

Ordering code

Heavy-duty PMK2 **B** **20** - **10** **R** **F**
 Standard P M K **B** **20** - **10** **R** **F**

Mount type

Symbol	Mount type	Suitable bore
B	Through-hole/Both ends tapped common(standard)	Ø12,Ø16
A	Both ends tapped common	Ø20~Ø63
B	Through-hole	
G	End cap flange	

G only for the body option F.
 Heavy-duty only have B, G options.

Bore

Null	Bore
16	Ø16mm
20	Ø20mm
25	Ø25mm
32	Ø32mm
40	Ø40mm
50	Ø50mm
63	Ø63mm

Ø16 no heavy-duty type

Gripping stroke

Code	Gripping stroke	Suitable bore
10	10mm	Ø16~Ø40
20	20mm	Ø16~Ø63
50	50mm	Ø50~Ø63

Body options

Symbol	Options
Null	Standard(rod female)
M	Rod both ends milling
F	End cap with table
N	With arm

No M for heavy duty

Rotation direction from open to close

Symbol	Rotation direction
R	Clockwise rotation
L	Anticlockwise rotation

Characteristic curve

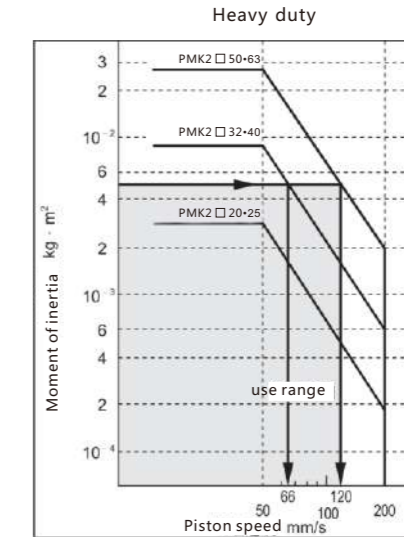
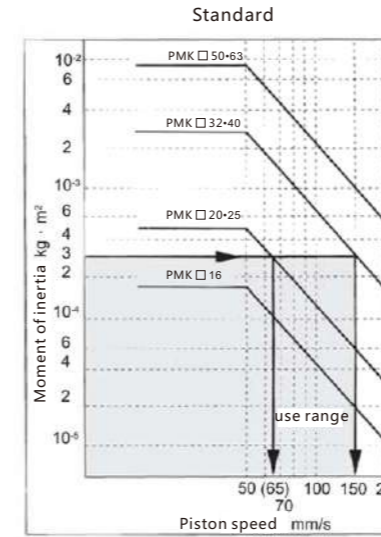

Dimensions (mm)

Through-hole(standard)/PMKB

Ø16

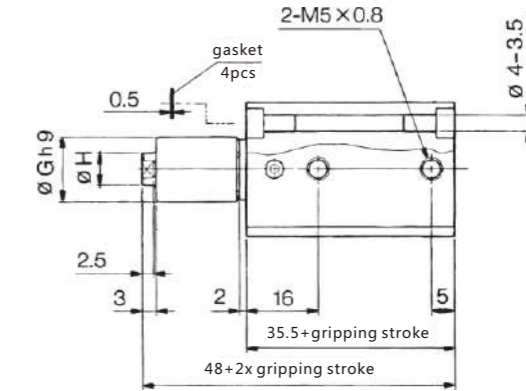
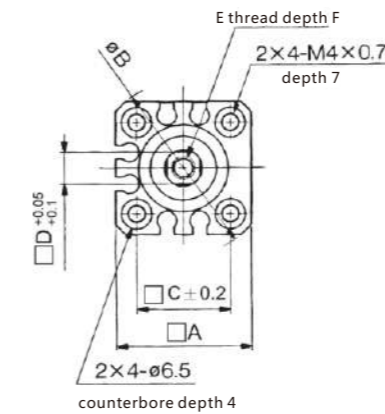

With arm/PMK□16-□□N

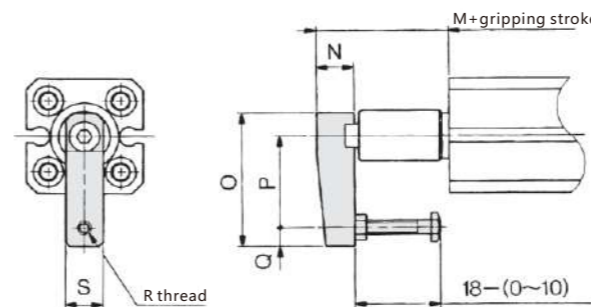

Standard

Series	A	B	C	D	E	F	Gh9	H
PMKB16	29	38	20	7	M5X0.8	6.5	14	8

With arm

Series	M	N	O	P	Q	R	S
PMKB16-□□N	21.5	11	36	25	5	M4X0.7	11

■ Dimensions (mm)

Through-hole(standard)/PMKB Ø20,Ø25

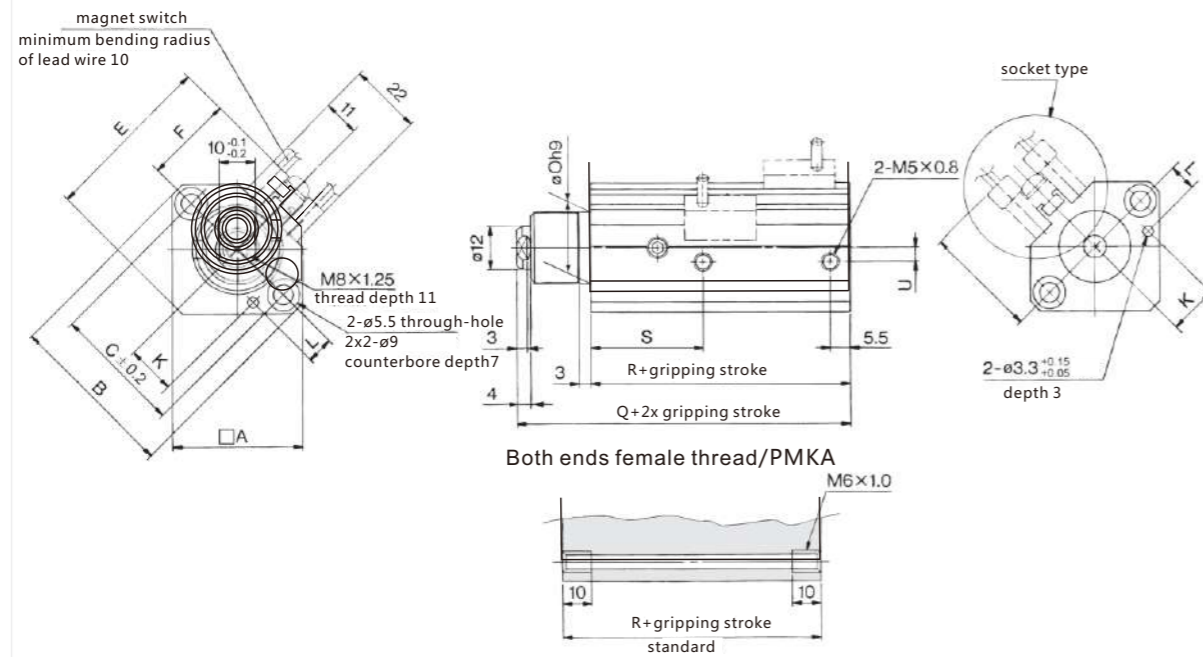

Series	A	B	C	E	F	K	L	Oh9	Q	R	S	U
PMKB20	36	46.8	36	48	24.5	13.5 ^{+0.15}	7.5 ^{+0.15}	20 ^{0.052}	72.5	62	31	4
PMKB25	40	52	40	53.8	27.5	16 ^{+0.15}	8 ^{+0.15}	23 ^{0.052}	73.5	63	32	5

Note: when the rod all extend, plus gripping stroke and rotation stroke to suitable size.

Head side flange/PMKG

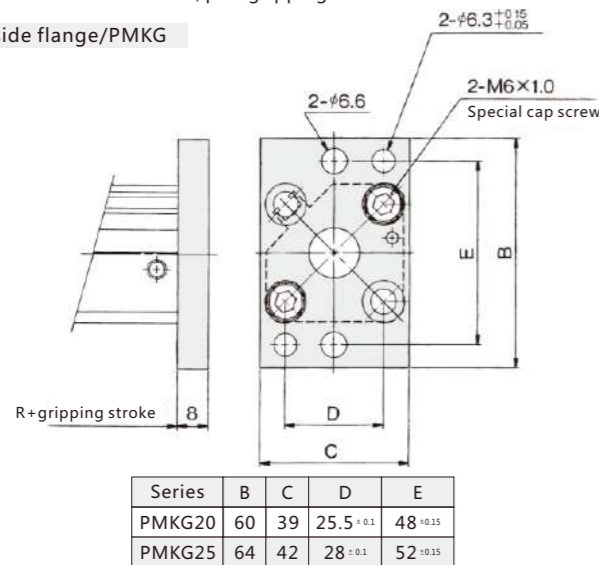

Head side table

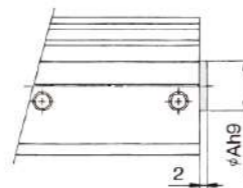

Series	Ah9
PMK□20-□□F	13 ^{0.043}
PMK□25-□□F	15 ^{0.043}

Series	B	C	D	E
PMKG20	60	39	25.5 ^{+0.1}	48 ^{+0.15}
PMKG25	64	42	28 ^{+0.1}	52 ^{+0.15}

With arms (PMK□□-□□N)

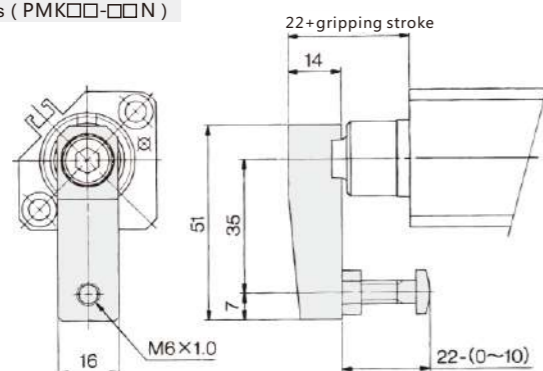

Both ends milling (PMK□□-□□M)

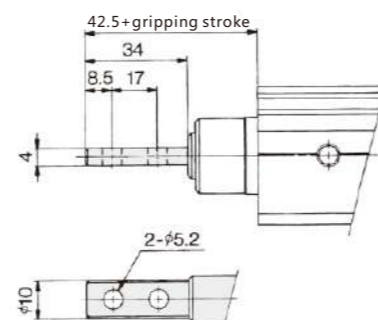

■ Dimensions (mm)

Through-hole(standard)/PMKB

Ø32,Ø40,Ø50,Ø63

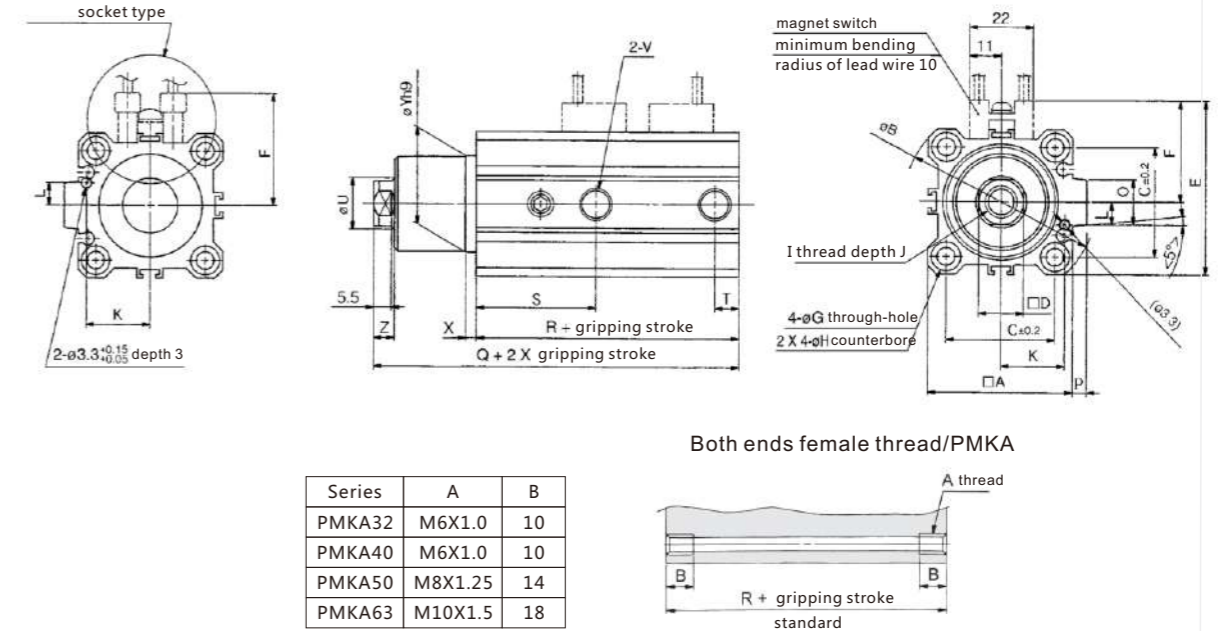

Series	A	B
PMKA32	M6X1.0	10
PMKA40	M6X1.0	10
PMKA50	M8X1.25	14
PMKA63	M10X1.5	18

Series	A	B	C	D	E	F	G	H	I	J	K	L	O	P	Q	R	S	T	U	V	X	Yh9	Z
PMKB32	45	60	34	14 ^{-0.1}	54	13.5	5.5	9 depth 7	M10X1.5	12	20 ^{+0.15}	7 ^{+0.15}	18	4.5	93.5	71.5	37	7.5	16	Rc1/8	3	30 ^{0.062}	6.5
PMKB40	52	69	40	14 ^{-0.1}	61	35	5.5	9 depth 7	M10X1.5	12	24 ^{+0.15}	7 ^{+0.15}	18	5	94.5	65	29.5	8	16	Rc1/8	3	30 ^{0.062}	6.5
PMKB50	64	86	50	17 ^{-0.1}	73	41	6.6	11 depth 8	M12X1.75	15	30 ^{+0.15}	8 ^{+0.15}	22	7	112	76.5	34	10.5	20	Rc1/4	3.5	37 ^{0.062}	7.5
PMKB63	77	103	60	17 ^{-0.1}	86	47.5	9	14 depth 10.5	M12X1.75	15	35 ^{+0.15}	9 ^{+0.15}	22	7	115	80	35	10.5	20	Rc1/4	3.5	48 ^{0.062}	7.5

Head side flange/PMKG

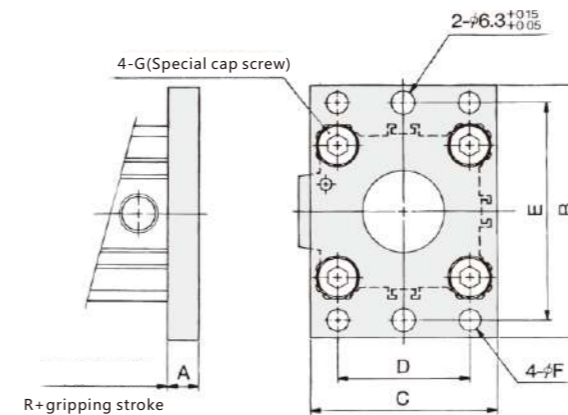

Head side table

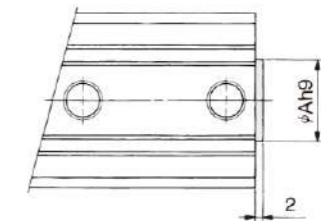

Series	A	B	C	D	E	F	C
PMKG32	8	65	48	34 ^{+0.1}	56 ^{+0.15}	5.5	M6X1.0
PMKG40	8	72	54	40 ^{+0.1}	62 ^{+0.15}	5.5	M6X1.0
PMKG50	9	89	67	50 ^{+0.1}	76 ^{+0.15}	6.6	M8X1.25
PMKG63	9	108	80	60 ^{+0.1}	92 ^{+0.15}	9	M10X1.5

Series	Ah9
PMK□32-□□F	21 ^{0.052}
PMK□40-□□F	28 ^{0.052}
PMK□50-□□F	35 ^{0.062}
PMK□63-□□F	35 ^{0.062}

■ Dimensions (mm)

With arms

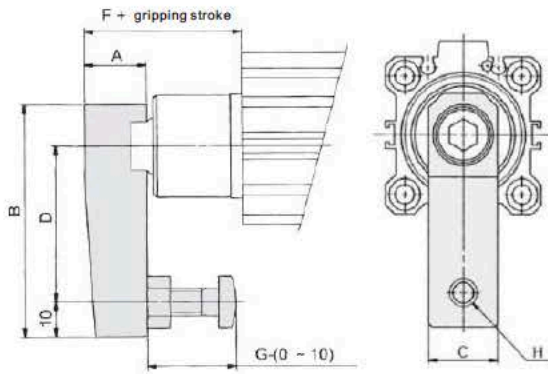

Series	A	B	C	D	F	G	H
PMK□32-□□N	18	67	20	45	35.5	25	M8X1.25
PMK□40-□□N	18	67	20	45	43	25	M8X1.25
PMK□50-□□N	22	88	22	65	53	40	M10X1.5
PMK□63-□□N	22	88	22	65	52.5	40	M10X1.5

Both ends milling

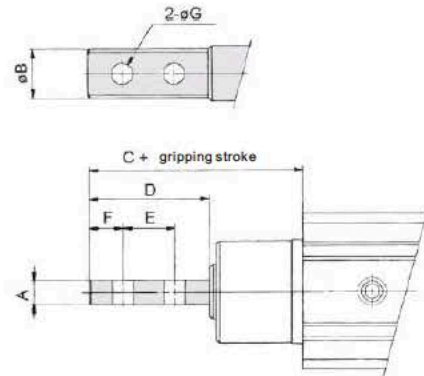

Series	A	B	C	D	E	F	G
PMK□B2-□□M	6	14	53.5	36	18	9	6.2
PMK□40-□□M	6	14	61	36	18	9	6.2
PMK□50-□□M	8	18	77	46	23	11.5	8.2
PMK□63-□□M	8	18	76.5	46	23	11.5	8.2