

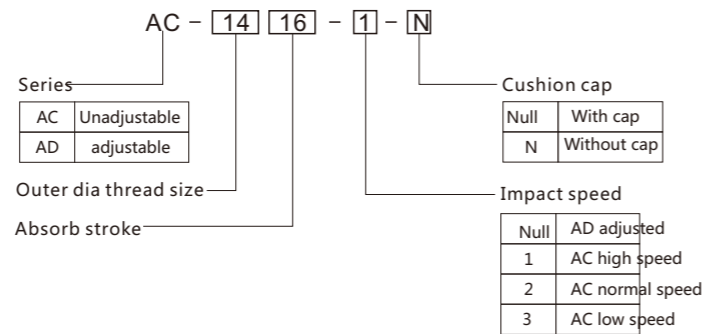

Ordering code



Specification

Series	Stroke mm	Max. absorb energy Nm	Absorb energy per hour Nm	Max. effective weight kg			Highest impact speed m/s			Operating temp. °C
				1	2	3	1	2	3	
AC-0806	6	2	8800	0.5	2	6	4	2	1	-36~80
AC-1005	5	3	10800	1	3	7	4	2	1	-36~80
AC-1008	8	4	15200	2	4	9	4	2	1	-36~80
AC-1210	10	5	17640	5	10	30	4	2	1	-36~80
AC-1412	12	18	30000	8	50	100	4	2	1	-36~80
AC-1416	16	20	36000	10	70	150	4	2	1	-36~80
AC-1425	25	30	38000	15	100	180	4	2	1	-36~80
AC-2020	20	40	40000	30	200	700	4.5	2.5	1	-36~80
AC-2030	30	50	48000	30	200	700	4.5	2.5	1	-36~80
AC-2040	40	60	55000	50	300	900	4.5	2.5	1	-36~80
AC-2050	50	70	60000	60	400	1200	4.5	2.5	1	-36~80
AC-2525	25	80	54000	200	800	1300	4.5	2.5	1	-36~80
AC-2540	40	120	75000	300	1000	1500	4.5	2.5	1	-36~80
AC-2550	50	130	90000	200	1100	1600	4.5	2.5	1	-36~80
AC-2580	80	150	120000	300	1300	2000	4	2.5	1	-36~80
AC-2725	25	140	85000	400	1000	2200	4	2.5	1	-36~80
AC-2750	50	200	95000	600	1500	2500	4	2.5	1	-36~80
AC-3325	25	160	75000	800	2000	2800	4	2.5	1	-36~80
AC-3350	50	280	85000	1200	2500	3400	4	2.5	1	-36~80
AC-3660	60	300	150000	1500	2800	4000	4	2.5	1	-36~80

Series	Stroke mm	Max. absorb energy Nm	Absorb energy per hour Nm	Max. effective weight kg	Highest impact speed m/s	Operating temp. °C
AD-1007	7	5	12400	12	3.5	-36~80
AD-1210	10	6	17640	30	3.5	-36~80
AD-1410	10	20	25000	80	3.5	-36~80
AD-1612	12	22	28000	160	3.5	-36~80
AD-2016	16	25	30000	200	3.5	-36~80
AD-2020	20	30	30000	250	3.5	-36~80
AD-2025	25	39	30000	312	3.5	-36~80
AD-2525	25	85	54000	400	3.5	-36~80
AD-2530	30	95	60000	480	3.5	-36~80
AD-2540	40	100	80000	700	3.5	-36~80
AD-2550	50	130	90000	720	4	-36~80
AD-2580	80	150	120000	800	4	-36~80
AD-2725	25	140	85000	560	4	-36~80
AD-2750	50	200	95000	1000	4	-36~80
AD-3650	50	350	100000	1400	4	-36~80
AD-4225	25	260	125000	3000	4.5	-36~80
AD-4250	50	500	150000	4000	4.5	-36~80
AD-4275	75	750	180000	6000	4.5	-36~80
AD-64050	50	2080	185000	12727	2	-36~80
AD-64100	100	4280	204000	18181	2	-36~80
AD-64150	150	6150	248000	23636	2	-36~80

Dimensions (mm)

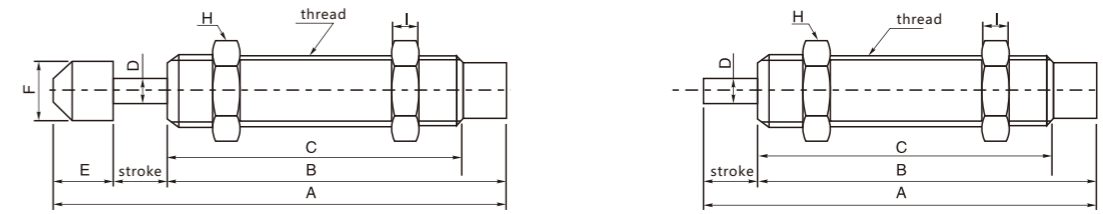

Series	Thread	Stroke (mm)	A	B	C	D	E	F	H	I
AC-0806	M8 x 1.0	6	50	38	33	3	6	6.6	11	3
AC-0806-N	M8 x 1.0	6	44	38	33	3	-	-	11	3
AC-1005	M10 x 1.0	5	38.7	27.7	22.9	3	6	8.6	12.7	3
AC-1005-N	M10 x 1.0	5	32.7	27.7	22.9	3	-	-	12.7	3
AC-1008	M10 x 1.0	8	57	43	38	3	6	8.6	12.7	3
AC-1008-N	M10 x 1.0	8	51	43	38	3	-	-	12.7	3
AC-1210	M12 x 1.0	10	69.5	50	45.5	3	9.5	10.3	14	4
AC-1210-N	M12 x 1.0	10	60	50	45.5	3	-	-	14	4
AC-1412	M14 x 1.5	12	102.3	76	67	4	14.3	12	19	6
AC-1412-N	M14 x 1.5	12	88	76	67	4	-	-	19	6
AC-1416	M14 x 1.5	16	125.3	95	86	4	14.3	12	19	6
AC-1416-N	M14 x 1.5	16	111	95	86	4	-	-	19	6
AC-1425	M14 x 1.5	25	149.3	110.2	101	4	14.3	12	19	6
AC-1425-N	M14 x 1.5	25	135	110.2	101	4	-	-	19	6
AC-2020	M20 x 1.5	20	148	110	101	6	18	18	26	8
AC-2020-N	M20 x 1.5	20	130	110	101	6	-	-	26	8
AC-2030	M20 x 1.5	30	158	110	101	6	18	18	26	8
AC-2030-N	M20 x 1.5	30	140	110	101	6	-	-	26	8
AC-2040	M20 x 1.5	40	179	121	110	6	18	18	26	8
AC-2040-N	M20 x 1.5	40	161	121	110	6	-	-	26	8
AC-2050	M20 x 1.5	50	235	167	158	6	18	18	26	8
AC-2050-N	M20 x 1.5	50	217	167	158	6	-	-	26	8
AC-2525	M25 x 1.5	25	155.5	111	101	8	19.5	22	32	10
AC-2525-N	M25 x 1.5	25	136	111	101	8	-	-	32	10
AC-2725	M27 x 1.5	25	143.8	100	87	8	18.8	22	36	10
AC-2725-N	M27 x 1.5	25	125	100	87	8	-	-	36	10
AC-2750	M27 x 1.5	50	208.8	140	127	8	18.8	22	36	10
AC-2750-N	M27 x 1.5	50	190	140	127	8	-	-	36	10

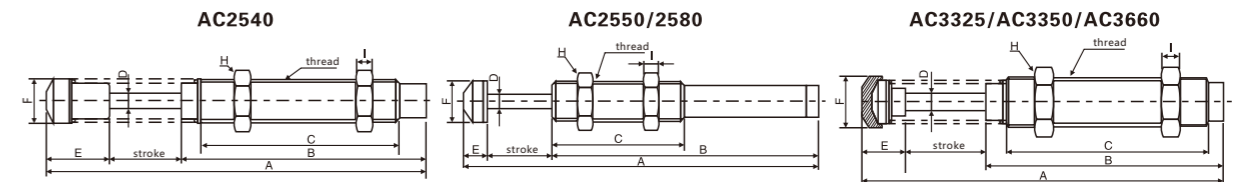

Series	Thread	Stroke (mm)	A	B	C	D	E	F	H	I
AC-2540	M25 x 1.5	40	213	137	117	8	36	22	32	10
AC-2550	M25 x 1.5	50	240	170.5	100	8	19.5	22	32	10
AC-2550-N	M25 x 1.5	50	240	170.5	100	8	19.5	22	32	10
AC-2580	M25 x 1.5	80	336.5	237	100	8	19.5	22	32	10
AC-2580-N	M25 x 1.5	80	336.5	237	100	8	19.5	22	32	10
AC-3325	M33 x 1.5	25	143	103	74.5	10	15	27.8	41	10
AC-3350	M33 x 1.5	50	208	143	114.5	10	15	27.8	41	10
AC-3660	M36 x 1.5	60	248	162	134	10	26	35	46	10

■ Dimensions (mm)

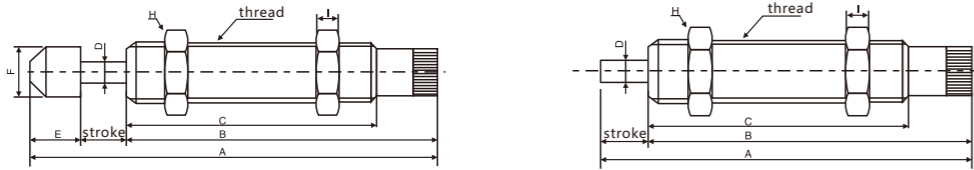

Series	Thread	Stroke (mm)	A	B	C	D	E	F	H	I
AD-1007	M10×1.0	7	79	58	44	3	7	8.5	12.7	3
AD-1007-N	M10×1.0	7	72	58	44	3	-	-	12.7	3
AD-1210	M12×1.0	10	78	61	46	3	7	8.5	14	4
AD-1210-N	M12×1.0	10	71	61	46	3	-	-	14	4
AD-1410	M14×1.5	10	112.8	88.5	72.5	4	14.3	12	19	6
AD-1410-N	M14×1.5	10	98.5	88.5	72.5	4	-	-	19	6
AD-1612	M16×1.5	12	117	90	76	4	15	13.5	19	6
AD-1612-N	M16×1.5	12	102	90	76	4	-	-	19	6
AD-2016	M20×1.5	16	151	117	101	4	18	18	26	8
AD-2016-N	M20×1.5	16	133	117	101	4	-	-	26	8
AD-2020	M20×1.5	20	136	98	75	6	18	18	26	8
AD-2020-N	M20×1.5	20	124	98	75	6	-	-	26	8
AD-2025	M20×1.5	25	160	117	101	6	18	18	26	8
AD-2025-N	M20×1.5	25	142	117	101	6	-	-	26	8
AD-2525	M25×1.5	25	163	118.5	101	8	19.5	22	32	10
AD-2525-N	M25×1.5	25	143.5	118.5	101	8	-	-	32	10
AD-2530	M25×1.5	30	168	118.5	101	8	19.5	22	32	10
AD-2530-N	M25×1.5	30	148.5	118.5	101	8	-	-	32	10
AD-2725	M27×1.5	25	153.8	110	90.2	8	18.8	23	36	10
AD-2725-N	M27×1.5	25	138.8	110	90.2	8	-	-	36	10
AD-2750	M27×1.5	50	218.8	150	130.2	8	18.8	23	36	10
AD-2750-N	M27×1.5	50	203.8	150	130.2	8	-	-	36	10

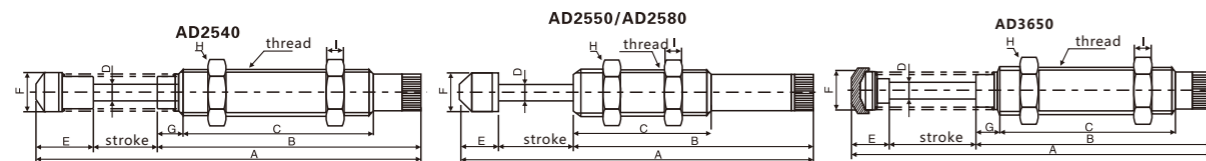

Series	Thread	Stroke (mm)	A	B	C	D	E	F	G	H	I
AD-2540	M25×1.5	40	220.5	144.5	117	8	36	22	10	32	10
AD-2550	M25×1.5	50	247.5	178	100	8	19.5	22	-	32	10
AD-2580	M25×1.5	80	344	244.5	100	8	19.5	22	-	32	10
AD-3650	M36×1.5	50	246.8	171	134	10	25.8	35.8	17	46	10

AD4225/AD4250/AD4275

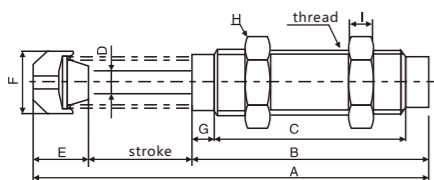

Series	Thread	Stroke (mm)	A	B	C	D	E	F	G	H	I
AD-4225	M42×1.5	25	186.4	127.5	88	12	33.9	44.5	28.5	50	15
AD-4250	M42×1.5	50	240.9	157	117.5	12	33.9	44.5	28.5	50	15
AD-4275	M42×1.5	75	301.4	187.5	148	12	33.9	44.5	28.5	50	15
AD-64050	UNF21/2-12	50	247.8	146	26	20	51.8	59	23	76.2	9.4
AD-64100	UNF21/2-12	100	347.8	196	26	20	51.8	59	23	76.2	9.4
AD-64150	UNF21/2-12	150	467.8	256	26	20	61.8	59	23	76.2	9.4

AD64050/AD64100/AD64150

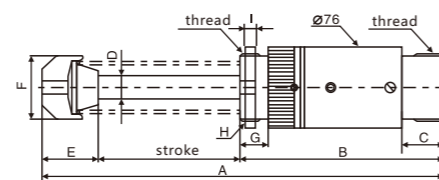

■ Specification

Series	Max. stroke	Max. load mass	Operating temp.
	mm	kgf	°C
HR-2412	12	350	-36~+80
HR-2415	15	350	-36~+80
HR-2430	30	350	-36~+80
HR-2460	60	350	-36~+80
HR-2480	80	350	-36~+80
HR-24100	100	350	-36~+80
HR-3140	40	550	-36~+80
HR-3160	60	550	-36~+80
HR-31100	100	550	-36~+80

■ Ordering code

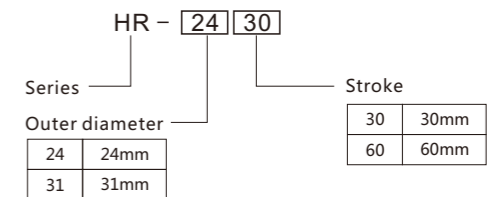

■ Dimensions (mm)

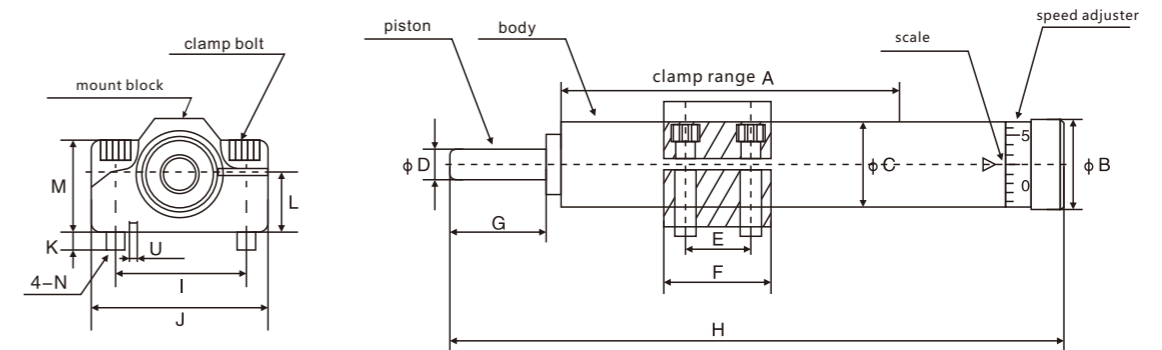

Symbol	A	B	C	D	E	F	G	H	I	J	K	L	M	N	U
HR-2412	68	28	24	9	20	32	12	142	38	52	7	17	28	5	2
HR-2415	85						15	155							
HR-2430	112						30	202							
HR-2460	156						60	277							
HR-2480	199						80	342							
HR-24100	232	100	395												
HR-3140	153	36	31	12	26	42	40	270	44	60	10	21	35	6	2
HR-3160	189						60	325							
HR-31100	269						100	405							